 = LEASED SPACE

 = BUILDING SUPPORT AREAS

 = BUILDING STAGING AREAS

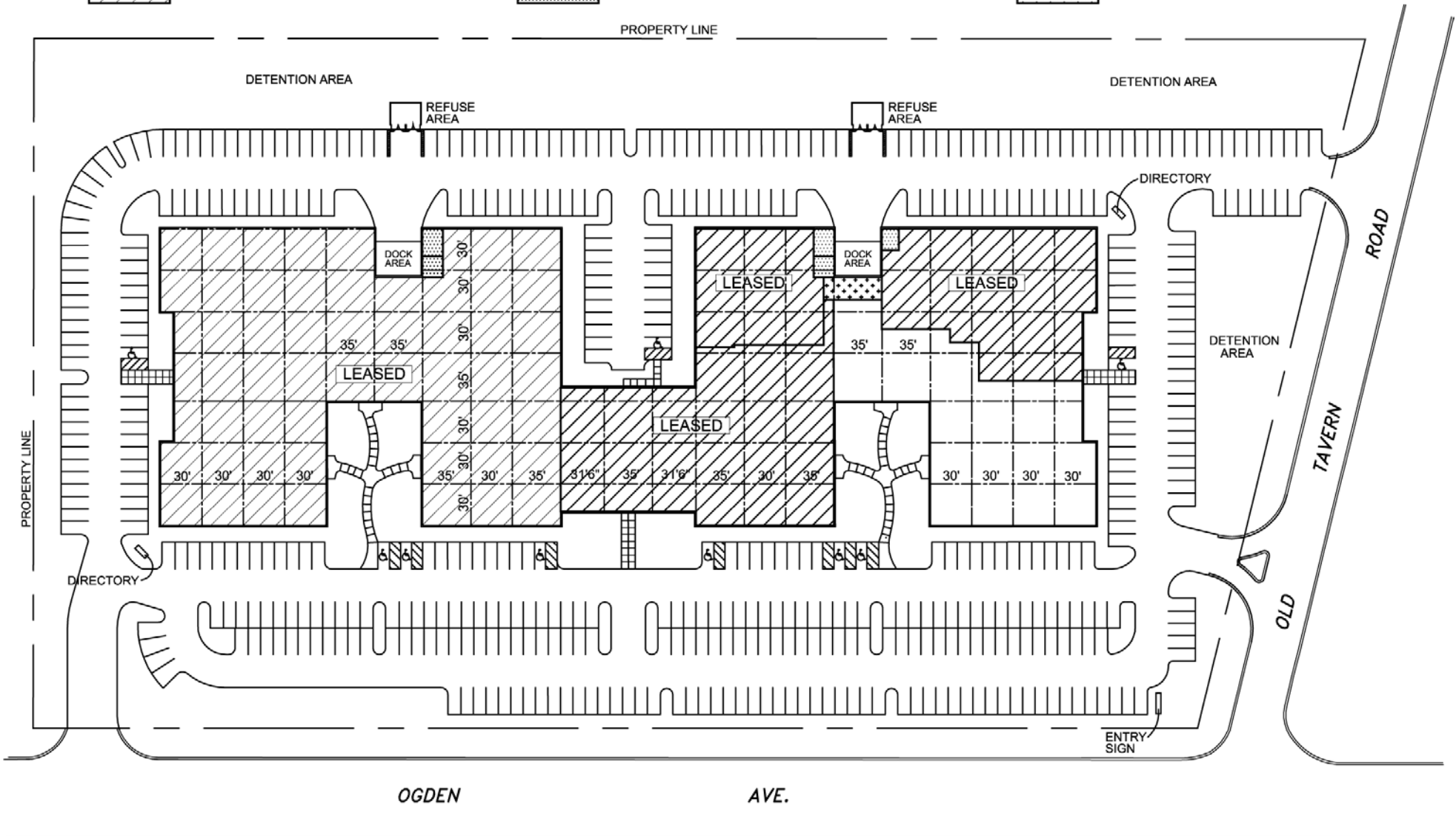

2400 OGDEN AVENUE LISLE, ILLINOIS

NORTH



SITE PLAN

0' 10' 25' 50' 100' 150' 200'

2400 OGDEN AVENUE

TOTAL BUILDING AREA 120,800 S.F.

TOTAL PARKING 508 SPACES

DATE: 9/21/06